

...for better
housing choices
for all Kentuckians.

Serving Kentucky

The Kentucky Manufactured Housing Institute (KMHI), we serve more than just our members, we serve Kentucky.

The KMHI knows that the best way to serve Kentucky, our communities, our homeowners, and our members is to provide access to educational opportunities and up to date information about factory built housing.

We understand that home buyers need to know they can buy a home that is well built, easy to maintain, energy efficient, with the design that they want, and at a price they can afford. All of these things are possible with factory built housing. Educated consumers make satisfied customers.

As an industry, we also know that educated, well informed public servants and governmental decision makers are as important to us as they are to any builder. The Kentucky Manufactured Housing Institute (KMHI) is dedicated to providing information, educational trainings, and presentations for the people of the Commonwealth. We value your understanding of the important role of the manufactured and modular housing industries in providing safe, affordable, and comfortable housing for Kentuckians.

Finally, our association knows how important it is for you to understand the vital roles of the federal, state and local government in guiding and regulating the construction and siting of homes and neighborhoods.



The Kentucky Manufactured Housing Institute is pleased to offer training and educational presentations for governmental decision makers and their staffs.

The KMHI would like the opportunity to share educational presentations and new material with your group and their guests. The KMHI will provide speakers to make these presentations. Depending on your needs and the logistics of your meetings, we can present a "stand alone" session, fit into your meeting agenda, or customize a presentation format. These sessions can also be used to meet the required training for planning officials in KRS 147A.027 (HB 55).

Frequently requested sessions provide:

- An introduction to factory built housing. What are the differences between the production criteria for a modular, manufactured and mobile home? How do federal, state and local laws and regulation guide the construction of these homes and their role in your community.
- Information on the latest innovations in factory built homes. Our new home styles are designed to be compatible in all kinds of neighborhoods. These homes may never be displayed at a home sales center, but can be custom ordered. What advances are allowing entire homes to be Energy Star rated using the Environmental Protection Agency standards? What is new in federal and state regulation?
- Options for local governments to encourage disposal of uninhabitable mobile homes. What are the challenges for a responsible property owner to properly clean up their land? How can the industry help?



The KMHI has facilitated sessions for:

- Many individual local and county governments
- Kentucky Chapter American Planning Association (KAPA)
- Kentucky Council of Area Development Districts (KCADD)
- Solid Waste Coordinators of Kentucky (SWaCK)
- Kentucky Association of Counties (KACo)
- Kentucky League of Cities (KLC)
- Code Administrators Association of Kentucky (CAAK)

The KMHI is glad to work with your organization's education or meeting scheduler. Our experience and core materials allow us to focus on your needs and to address your issues for future trainings, conferences, or meeting agendas. For accredited trainings we are pleased to provide these materials in a format that complies with your applicable procedures.

If you have any questions or would like to discuss potential dates please contact us at 502.223.0490 or kmhi@kmhi.org



The Kentucky Manufactured Housing Institute's legislative priorities are tied to enhancing industry practices and supporting clarity and balance in regulation.

Our web site www.kmhi.org provides links to federal, state, and local sources of information. For local jurisdictions in the Commonwealth we provide free downloadable documents:

- Suggested Policy on Zoning and Land Use Regulations for Manufactured Housing
- Model Ordinance: Zoning and Land Use Regulations for Manufactured Housing
- Local Government Official's Training: Manufactured Housing - Who Does What?
- Options for Removing Unusable Mobile Homes - Landowner
- Disposal of Uninhabitable Mobile Homes - Success Using a Big Carrot and a Little Stick, County and Local Governments

You can also use www.kmhi.org to find useful links, books, and articles about technical issues, land use policy, customer satisfaction, safety, consumer protection, and more.

An Act Relating to Nuisance Abatement

"Any city, county, consolidated local government, or urban-county may establish by ordinance reasonable standards and procedures for the enforcement of this section."



The Kentucky Manufactured Housing Institute (KMHI) is a trade association representing the manufactured and modular housing industries. These industries provide safe, affordable, and comfortable housing for Kentuckians of all ages, races, educational levels, ethnic backgrounds, and income levels.

The Kentucky Manufactured Housing Institute supports their members in maintaining their training, education, and certifications. The people who design, build, install, sell, and finance homes have access to the best industry practices available.

We support progressive laws and regulations. The manufactured housing industry in Kentucky already has a decade of experience with providing protections to the buyers of manufactured homes required in 2005 by the federal government. The KMHI supports training and certification of industry professionals and a dispute resolution process.



Contact the KMHI at
(502) 223-0490, fax: (502) 223-7305
email: kmhi@kmhi.org
2710 U.S. 127 South
Frankfort, Kentucky 40601
www.kmhi.org

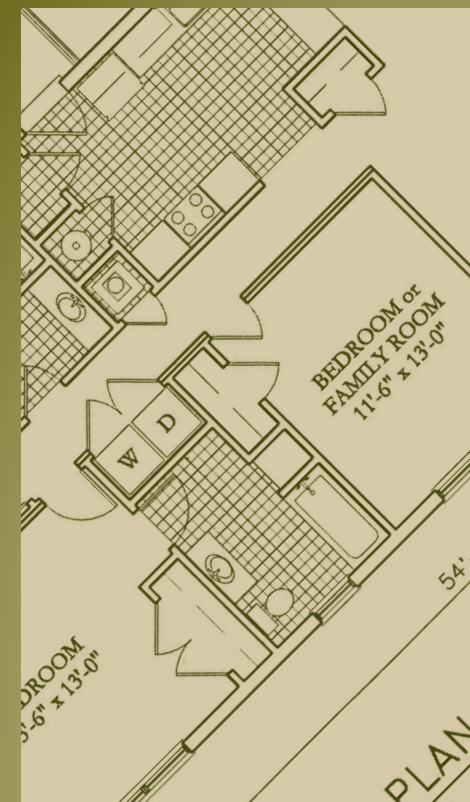

the right choice

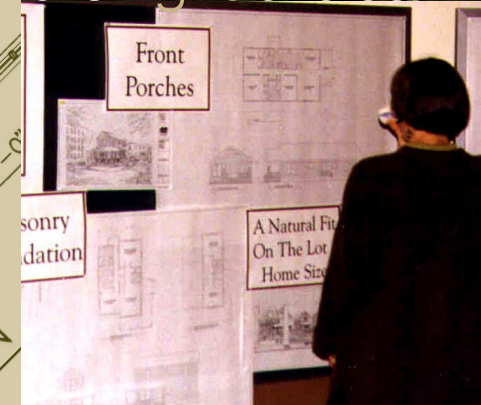

Manufactured and Modular Homes



Working proactively with local governments...